

**Drain:** KINGSBOROUGH DRAIN **Drain #:** 297  
**Improvement/Arm:** KINGSBOROUGH-SECTION 4  
**Operator:** SLM/JRH **Date:** 1-9-04  
**Drain Classification:** Urban/Rural **Year Installed:** 2001

### GIS Drain Input Checklist

- Pull Source Documents for Scanning JRH 1-9
- Digitize & Attribute Tile Drains N/A
- Digitize & Attribute Storm Drains SLM/JRH 1-9
- Digitize & Attribute SSD SLM/JRH 1-9
- Digitize & Attribute Open Ditch SLM/JRH 1-9
- Stamp Plans SLM/JRH 1-9
- Sum drain lengths & Validate SLM/
- Enter Improvements into Posse SLM/
- Enter Drain Age into Posse JRH 1-22
- Sum drain length for Watershed in Posse JRH 1-22
- Check Database entries for errors SLM/

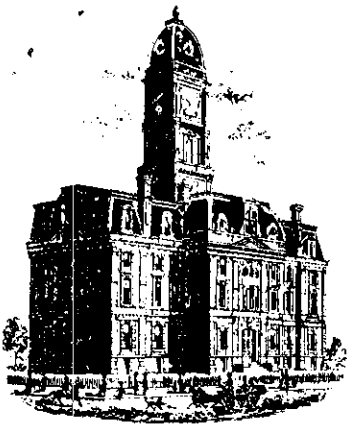



SURVEYOR'S OFFICE

# Hamilton County

*Kenton C. Ward, Surveyor*

*Phone (317) 776-8495*

*Fax (317) 776-9628*

*Suite 188*

*One Hamilton County Square  
Noblesville, Indiana 46060-2230*

To: Hamilton County Drainage Board

July 16, 2001

Re: Kingsborough Drain, Section 4 Arm

Attached is a petition, non-enforcement request, plans, calculations, quantity summary and assessment roll for the Section 4 arm, Kingsborough Drain. I have reviewed the submittals and petition and have found each to be in proper form.

I have made a personal inspection of the land described in the petition. Upon doing so, I believe that the drain is practicable; will improve the public health; benefit a public highway and be of public utility; and that the costs, damages, and expenses of the proposed drain will probably be less than the benefits accruing to the owners of land likely to be benefited. The drain will consist of the following:

6"	SSD	2,840 ft	21"	RCP	382 ft	36"	RCP - 154 ft
12"	RCP	498 ft	24"	RCP	330 ft	Open Ditch - 115 ft	
18"	RCP	175 ft	27"	RCP	432 ft		

The total length of the drain will be 4,926 feet.

The open ditch listed above is that length of swale between Str. 892 and the 12" RCP located at the South West corner of Common Area #4. This swale runs along the South line of Common Area #4.

The subsurface drains (SSD) to be part of the regulated drain are those located under the curbs and those main lines between lots or in rear yards. Only the main SSD lines, which are located within the easement (right of way), are to be maintained as regulated drain. Laterals for individual lots will not be considered part of the regulated drain. The portion of the SSD which will be regulated other than those under curbs are as follows: Rear of Lots 101 and 102.

I have reviewed the plans and believe the drain will benefit each lot equally. Therefore, I recommend each lot be assessed equally. I also believe that no damages will result to landowners by the construction of this drain. I recommend a maintenance assessment of \$30.00 per lot, \$5.00 per acre for roadways, with a \$30.00 minimum. With this assessment the total annual assessment for this drain/this section will be \$639.10.

Parcels assessed for this drain may also be assessed for the Collins Osborn or Williams Creek Drain at sometime in the future.

I believe this proposed drain meets the requirements for Urban Drain Classification as set out in IC 36-9-27-67 to 69. Therefore, this drain shall be designated as an Urban Drain.

I recommend that upon approval of the above proposed drain that the Board also approve the attached non-enforcement request. This request is for the reduction of the regulated drain easement to those easement widths as shown on the secondary plat for Kingsborough, section 4 as recorded in the office of the Hamilton County Recorder.

I recommend the Board set a hearing for this proposed drain for August 27, 2001.

KCW/llm

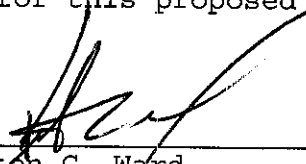
  
\_\_\_\_\_  
Kenton C. Ward  
Hamilton County Surveyor

**PERFORMANCE BOND**

**KNOW ALL MEN BY THESE PRESENTS** that, DREES PREFERRED COLLECTION, INC., as Principal, and American Motorists Insurance Company, as Surety, are held and firmly bound unto Hamilton County Commissioners, 1 Hamilton County Square, Noblesville, IN 46060, as Obligee, in the sum of Seventy-Seven Thousand Three Hundred Four and 00/100 Dollars (\$77,304.00) lawful money of the United States for the payment of which, well and truly be made, we bind ourselves, our heirs, executors, successors and assigns, jointly and severally, firmly by these presents.

**WHEREAS**, the Principal has entered into a "Subdividers Contract" with Hamilton County Commissioners for Storm Sewers in Kingsborough Section 4 Subdivision.

**NOW THEREFORE**, if the said Principal hereinbefore set forth, shall fully and faithfully perform all the work specified to be done in accordance with plans for Kingsborough Section 4 Subdivision , on record at Hamilton County Commissioners, then this obligation shall be void and of no further legal effect; otherwise, this bond shall remain in full force and effect in law; it being expressly understood and agreed that the liability of the Surety for any and all claims hereunder, shall in no event exceed the penal amount of this obligation, as herein stated to be the sum of Seventy-Seven Thousand Three Hundred Four and 00/100 Dollars (\$77,304.00) and no more.

**SIGNED AND DATED THIS** 3rd day of May, 2001.

Principal: Drees Preferred Collection, Inc.

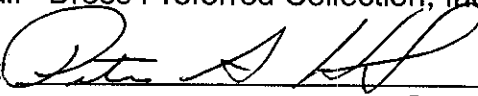
By:   
INDIANAPOLIS DIV MGR

Surety: American Motorists Insurance Company

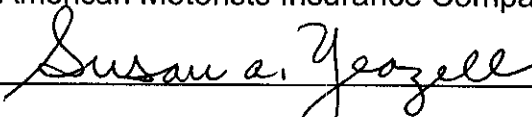
By:   
Susan A. Yeazell, Attorney-in-Fact

Home Office: Long Grove, IL 60049

## POWER OF ATTORNEY

Know All Men By These Presents:

That the Lumbermens Mutual Casualty Company, the American Motorists Insurance Company, and the American Manufacturers Mutual Insurance Company, corporations organized and existing under the laws of the State of Illinois, having their principal office in Long Grove, Illinois, (hereinafter collectively referred to as the "Company") do hereby appoint

Dan E. Ries and Susan A. Yeazell of Cincinnati, Ohio (EACH)\*\*\*\*\*

their true and lawful agent(s) and attorney(s)-in-fact, to make, execute, seal, and deliver during the period beginning with the date of issuance of this power and ending on the date specified below, unless sooner revoked for and on its behalf as surety, and as their act and deed:

Any and all bonds and undertakings\*\*\*\*\*

EXCEPTION: NO AUTHORITY is granted to make, execute, seal and deliver any bond or undertaking which guarantees the payment or collection of any promissory note, check, draft or letter of credit.

This authority does not permit the same obligation to be split into two or more bonds in order to bring each such bond within the dollar limit of authority as set forth herein.

This appointment may be revoked at any time by the Company.

The execution of such bonds and undertakings in pursuance of these presents shall be as binding upon the said Company as fully and amply to all intents and purposes, as if the same had been duly executed and acknowledged by their regularly elected officers at their principal office in Long Grove, Illinois.

THIS APPOINTMENT SHALL CEASE AND TERMINATE WITHOUT NOTICE AS OF December 31, 2001

This Power of Attorney is executed by authority of resolutions adopted by the Executive Committees of the Boards of Directors of the Company on February 23, 1988 at Chicago, Illinois, true and accurate copies of which are hereinafter set forth and are hereby certified to by the undersigned Secretary as being in full force and effect:

"VOTED, That the Chairman of the Board, the President, or any Vice President, or their appointees designated in writing and filed with the Secretary, or the Secretary shall have the power and authority to appoint agents and attorneys-in-fact, and to authorize them to execute on behalf of the Company, and attach the seal of the Company thereto, bonds and undertakings, recognizances, contracts of indemnity and other writings, obligatory in the nature thereof, and any such officers of the Company may appoint agents for acceptance of process."

This Power of Attorney is signed, sealed and certified by facsimile under and by authority of the following resolution adopted by the Executive Committee of the Boards of Directors of the Company at a meeting duly called and held on the 23rd day of February, 1988:

"VOTED, That the signature of the Chairman of the Board, the President, any Vice President, or their appointees designated in writing and filed with the Secretary, and the signature of the Secretary, the seal of the Company, and certifications by the Secretary, may be affixed by facsimile on any power of attorney or bond executed pursuant to resolution adopted by the Executive Committee of the Board of Directors on February 23, 1988 and any such power so executed, sealed and certified with respect to any bond or undertaking to which it is attached, shall continue to be valid and binding upon the Company."

In Testimony Whereof, the Company has caused this instrument to be signed and their corporate seals to be affixed by their authorized officers, this November 2, 2000.

Attested and Certified:

Lumbermens Mutual Casualty Company  
American Motorists Insurance Company  
American Manufacturers Mutual Insurance Company

*Robert P. Hames*



*J S Kemper III*

Robert P. Hames, Secretary

by

J. S. Kemper, III, Exec. Vice President

**PERFORMANCE BOND**

**KNOW ALL MEN BY THESE PRESENTS** that, DREES PREFERRED COLLECTION, INC., as Principal, and American Motorists Insurance Company, as Surety, are held and firmly bound unto Hamilton County Commissioners, 1 Hamilton County Square, Noblesville, IN 46060, as Obligee, in the sum of Sixteen Thousand Five Hundred Fifty and 00/100 Dollars (\$16,550.00) lawful money of the United States for the payment of which, well and truly be made, we bind ourselves, our heirs, executors, successors and assigns, jointly and severally, firmly by these presents.

**WHEREAS**, the Principal has entered into a "Subdividers Contract" with Hamilton County Commissioners for Sub-Surface Drains in Kingsborough Section 4 Subdivision.

**NOW THEREFORE**, if the said Principal hereinbefore set forth, shall fully and faithfully perform all the work specified to be done in accordance with plans for Kingsborough Section 4 Subdivision , on record at Hamilton County Commissioners, then this obligation shall be void and of no further legal effect; otherwise, this bond shall remain in full force and effect in law; it being expressly understood and agreed that the liability of the Surety for any and all claims hereunder, shall in no event exceed the penal amount of this obligation, as herein stated to be the sum of Sixteen Thousand Five Hundred Fifty and 00/100 Dollars (\$16,550.00) and no more.

**SIGNED AND DATED THIS** 3rd day of May, 2001.

Principal: Drees Preferred Collection, Inc.

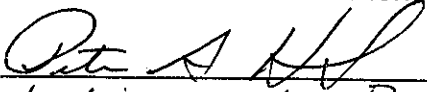
By:   
Indianapolis Div Mgr.

Surety: American Motorists Insurance Company

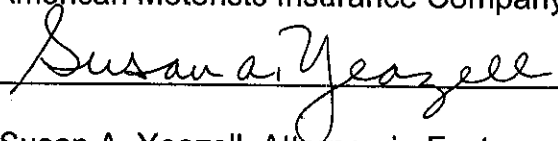
By:   
Susan A. Yeazell, Attorney-in-Fact

Home Office: Long Grove, IL 60049

## POWER OF ATTORNEY

Know All Men By These Presents:

That the Lumbermens Mutual Casualty Company, the American Motorists Insurance Company, and the American Manufacturers Mutual Insurance Company, corporations organized and existing under the laws of the State of Illinois, having their principal office in Long Grove, Illinois, (hereinafter collectively referred to as the "Company") do hereby appoint

Dan E. Ries and Susan A. Yeazell of Cincinnati, Ohio (EACH)\*\*\*\*\*

their true and lawful agent(s) and attorney(s)-in-fact, to make, execute, seal, and deliver during the period beginning with the date of issuance of this power and ending on the date specified below, unless sooner revoked for and on its behalf as surety, and as their act and deed:

Any and all bonds and undertakings\*\*\*\*\*

EXCEPTION: NO AUTHORITY is granted to make, execute, seal and deliver any bond or undertaking which guarantees the payment or collection of any promissory note, check, draft or letter of credit.

This authority does not permit the same obligation to be split into two or more bonds in order to bring each such bond within the dollar limit of authority as set forth herein.

This appointment may be revoked at any time by the Company.

The execution of such bonds and undertakings in pursuance of these presents shall be as binding upon the said Company as fully and amply to all intents and purposes, as if the same had been duly executed and acknowledged by their regularly elected officers at their principal office in Long Grove, Illinois.

THIS APPOINTMENT SHALL CEASE AND TERMINATE WITHOUT NOTICE AS OF December 31, 2001

This Power of Attorney is executed by authority of resolutions adopted by the Executive Committees of the Boards of Directors of the Company on February 23, 1988 at Chicago, Illinois, true and accurate copies of which are hereinafter set forth and are hereby certified to by the undersigned Secretary as being in full force and effect:

"VOTED, That the Chairman of the Board, the President, or any Vice President, or their appointees designated in writing and filed with the Secretary, or the Secretary shall have the power and authority to appoint agents and attorneys-in-fact, and to authorize them to execute on behalf of the Company, and attach the seal of the Company thereto, bonds and undertakings, recognizances, contracts of indemnity and other writings, obligatory in the nature thereof, and any such officers of the Company may appoint agents for acceptance of process."

This Power of Attorney is signed, sealed and certified by facsimile under and by authority of the following resolution adopted by the Executive Committee of the Boards of Directors of the Company at a meeting duly called and held on the 23rd day of February, 1988:

"VOTED, That the signature of the Chairman of the Board, the President, any Vice President, or their appointees designated in writing and filed with the Secretary, and the signature of the Secretary, the seal of the Company, and certifications by the Secretary, may be affixed by facsimile on any power of attorney or bond executed pursuant to resolution adopted by the Executive Committee of the Board of Directors on February 23, 1988 and any such power so executed, sealed and certified with respect to any bond or undertaking to which it is attached, shall continue to be valid and binding upon the Company."

In Testimony Whereof, the Company has caused this instrument to be signed and their corporate seals to be affixed by their authorized officers, this November 2, 2000.

Attested and Certified:

Lumbermens Mutual Casualty Company  
American Motorists Insurance Company  
American Manufacturers Mutual Insurance Company

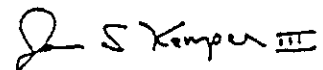
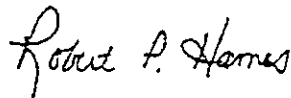

Robert P. Hames, Secretary

by

J. S. Kemper, III, Exec. Vice President



CERTIFICATE OF COMPLETION AND COMPLIANCE  
KINGSBOROUGH, SECTION 4

Address of premises on which  
land alteration was accomplished 141st Street and Ditch Road

Inspection Date(s): \_\_\_\_\_ Permit No. \_\_\_\_\_

Relative to plans prepared by: Stoepelwerth and Associates, Inc.

on November 11, 2000

I hereby certify that:

To the best of my knowledge, information and belief such land  
alteration has been performed and completed in conformity with the improved  
plan, except None

Signature *D. J. Stoepelwerth* Date: September 5, 2001

Typed Name: David J. Stoepelwerth Phone: (317 849-5935)

Business Address 9940 Allisonville Rd.,  
Fishers, Indiana 46038

Surv. \_\_\_\_\_ Engr. X Arch. \_\_\_\_\_ Indiana Registration No. 19358  
90474

(SEAL)



10265COM/IWP/FORM

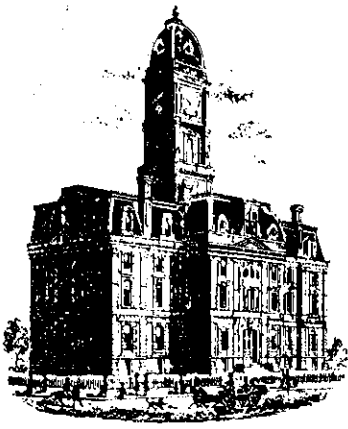

SURVEYOR'S OFFICE

# Hamilton County

*Kenton C. Ward, Surveyor*

*Phone (317) 776-8495*

*Fax (317) 776-9628*

*Suite 188*

*One Hamilton County Square*

*Noblesville, Indiana 46060-2230*

**To: Hamilton County Drainage Board**

**April 4, 2002**

**Re: Kingsborough Drain: Sec. 4 Arm**

Attached are as-builts, certificate of completion & compliance, and other information for Kingsborough Sec. 4. An inspection of the drainage facilities for this section has been made and the facilities were found to be complete and acceptable.

During construction, changes were made to the drain, which will alter the plans submitted with my report for this drain-dated July 16, 2001. The report was approved by the Board on August 27, 2001 and can be found in DR Book 6 - pages 125-126. The changes are as follows:

Structure:	T.C.:	I.E.:	Pipe:	Length:	Original Plans:	Difference:
884	895.7	890.96				
883	895.04	890.64	12	74		
883	895.04	890.64				
882	892.38	888.46	12	169	166	3
882	892.38	888.46				
881	891.36	888.12	27	180	178	-2
892	896.79	893.53				
891	896.1	892.38	12	239	240	-1
891	896.1	892.38				
890	897.05	892	18	128	135	-7
890	897.05	892				
889	896.74	891.85	18	38	40	-2
889	896.74	891.85				
888	897.36	891.76	21	29	28	1
882	892.38	888.46				
882a	893.68	889.32	24	297	300	-3
882a	893.68	889.32				
882b		891.68	24	30		
881	891.36	888.12				
880	894.87	887.66	27	184		
880	894.87	887.66				

879	894.86	887.02	27	70		
879	894.86	887.02				
existing	891.55	886.53	36	151	154	3
888	897.36	891.92				
887	895.07	891.22	21	150		
887	895.07	891.22				
886	895.11	890.98	21	30		
886	895.11	890.98				
existing	895.4	890.24	21	176	174	2

**6" SSD Streets:**

Kingsgate Dr	798.01
Trailwind Court	347.15
Saffron Cir	244.58
x2	1389.74
<b>Total:</b>	<b>2779.48</b>

**lots:**

101-102	239
<b>Total:</b>	<b>239</b>

**RCP Pipe Totals:**

12	500
18	166
21	385
24	327
27	434
36	151

**Other Drain Totals:**

Open Drain (Swale)	115

The length of the drain due to the changes described above is now **5096 feet**.

The non-enforcement was approved by the Board at its meeting on August 27, 2001 and recorded under instrument #200169284.

The bond or letter of credit from American Motorists Insurance Company, number 3SM004557, 3SM004558; dated May 2, 2001 & June 11, 2001; in the amount of \$77,304.00 for storm sewers and \$16,550.00 for subsurface drains; was released February 25, 2002.

I recommend the Board approve the drain's construction as complete and acceptable.

Sincerely,

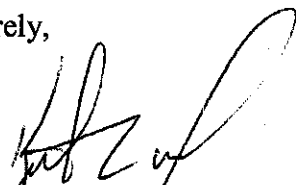

\_\_\_\_\_  
Kenton C. Ward,  
Hamilton County Surveyor

KCW/slm

SCALE: 1" = 50'

LEGEND

- ASBUILT GRADE ELEV.
  - EXISTING CONTOUR
  - EXISTING SANITARY SEWER
  - EXISTING STORM SEWER
  - PROPOSED GRADE
  - PROPOSED CONTOUR
  - PROPOSED SANITARY SEWER
  - PROPOSED STORM SEWER
  - PROPOSED SWALE
  - PROPOSED 4' SIDEWALK (BY HOME BUILDER) (UNLESS OTHERWISE NOTED)
- 35**  
853.0  
★  
LOT NUMBER  
PAD ELEVATION  
PAD SIZE 70'x60' (UNLESS OTHERWISE NOTED)
- B.L.O.** BASEMENT LOOK OUT  
 PROPOSED 6" UNDERDRAINS
- 4" S.S.D. TO LOT  
 6" S.S.D. TO LOT

BENCHMARKS:

USGS  
BRASS TABLET MARKED 93RHP DATED 1951 SET IN 4'x4' CONC. POST @ S.W. CORNER INT. 146th & DITCH ROAD 16' S. OF 146th & 23' W. OF DITCH ROAD 6' S.W. OF PWP & 4' W. OF N.E. CORNER FENCE POST.  
ELEV.=903.373

TBM #1  
BOAT SPIKE IN PWP 2' UP ON NORTH SIDE 400' SOUTH OF N.W. CORNER OF OUR TRACT.  
ELEV.=901.51

TBM #2  
1049 W. 141st STREET. BOAT SPIKE IN PWP 2' UP ON N. SIDE.  
ELEV.=891.06

EARTHWORK:

1. EXCAVATION
  - A. Excavated material that is suitable may be used for fills. All unsuitable material and all surplus excavated material not required shall be removed from the site.
  - B. Provide and place any additional fill material from offsite as may be necessary to produce the grades required on plans. Fill obtained from offsite shall be of quality as specified for fills herein and the source approved by the Developer. It will be the responsibility of the Contractor for any costs for fill needed.
2. REMOVAL OF TREES
  - A. All trees and stumps shall be removed from areas to be occupied by a road surface or structure area. Trees and stumps shall not be buried on site.
3. PROTECTION OF TREES
  - A. The Contractor shall, at the direction of the Developer, endeavor to save and protect trees of value and worth which do not impair construction of improvements as designed.
  - B. In the event cut or fill exceeds 0.5 foot over the root area, the Developer shall be consulted with respect to protective measure to be taken, if any, to preserve such trees.
4. REMOVAL OF TOPSOIL
  - A. All topsoil shall be removed from all areas beneath future pavements or building. Topsoil removal shall be to a minimum depth of 6 inches or to the depth indicated in the geotechnical report provided by the Developer to be excavated or filled. Topsoil should be stored at a location where it will not interfere with construction operations. The topsoil shall be free of debris and stones.
5. UTILITIES
  - A. Rules and regulation governing the respective utility shall be observed in executing all work under this section.
  - B. It shall be the responsibility of the Contractor to determine the location of existing underground utilities 2 working days prior to commencing work. For utility locations to be marked call Toll Free 1-800-382-5544 within Indiana or 1-800-428-5200 outside Indiana.
6. SITE GRADING
  - A. Do all cutting, filling, compacting of fills and rough grading required to bring entire project area to subgrade as shown on the drawing.
  - B. The tolerance for paved areas shall not exceed 0.10 feet above established subgrade. All other areas shall not exceed 0.10 feet plus or minus the established grade. Provide roundings at top and bottom of banks and other breaks in grade.
  - C. The Engineer shall be notified when the Contractor has reached the tolerance as stated above, so that field measurements and spot elevations can be verified by the Engineer. The Contractor shall not remove his equipment from the site until the Engineer has verified that the job meets the above tolerance.

FORM/EARTHWRK

ALL PADS SHOULD BE TESTED TO ASSURE A COMPACTION OF AT LEAST 95 PERCENT OF THE MAXIMUM DRY DENSITY USING THE STANDARD PROCTOR TEST METHOD.

NOTE: DECORATIVE SIGNS, SPRINKLER SYSTEMS, TREES, LANDSCAPING MOUNDS, LIGHT POLES OR OTHER SUCH AMENITIES ARE NOT PERMITTED IN THE RIGHT OF WAY.

STORM TABLE

Str. No.	Type	Tc/Rim	Inverts	Dir.
879	CURB INLET	894.67	886.99	(E)(NW)
880	CURB INLET	894.67	887.20	(NW)(SE)
881	YARD INLET	891.10	887.75	(SE)(W)
882	YARD INLET	892.00	888.50	(SW)
882A	YARD INLET	893.70	888.65	(E)(W)
882B	CONC. END SECTION		889.18	(W)
883	CURB INLET	895.10	890.70	(NE)(SW)
884	CURB INLET	897.77	890.92	(NE)(W)
886	CURB INLET	891.02	891.02	(E)(W)
887	CURB INLET	895.11	891.14	(E)(W)
888	YARD INLET	895.40	891.74	(E)(S)
889	CURB INLET	896.86	891.82	(N)(SW)
890	CURB INLET	897.04	891.94	(NE)(S)
891	YARD INLET	896.10	892.34	(N)(W)
892	YARD INLET	897.10	893.54	(E)

RECORD DRAWING

*Jeffery W. Darling*  
JEFFERY W. DARLING  
Registered Land Surveyor  
No. 900017

8/20/01

DATE



This information was gathered for input into the Hamilton County Geographical Information System. This document is considered an GIS.

Entry Date: 2/14/02  
Entered by: Suzanne L. Davis  
JWH - P-241

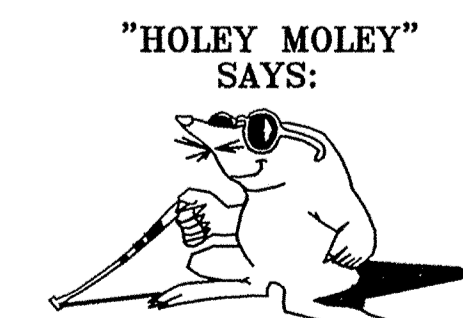

1-800-382-5544  
CALL TOLL FREE  
1-800-428-5200  
FOR CALLS OUTSIDE OF INDIANA

CAUTION

LOCATION OF ALL EXISTING UNDERGROUND UTILITIES SHOWN ON THIS PLAN ARE BASED UPON ABOVE GROUND EVIDENCE (including, but not limited to, manholes, inlets, valves, & marks made upon the ground by others) AND ARE SPECULATIVE IN NATURE. THERE MAY ALSO BE OTHER EXISTING UNDERGROUND UTILITIES FOR WHICH THERE IS NO ABOVE GROUND EVIDENCE OR FOR WHICH NO ABOVE GROUND EVIDENCE WAS OBSERVED. THE EXACT LOCATIONS OF SAID EXISTING UNDERGROUND UTILITIES SHOULD BE VERIFIED BY THE CONTRACTOR PRIOR TO ANY AND ALL CONSTRUCTION.

FILED  
SEP 06 2001

SITE DEVELOPMENT PLAN  
KINGSBOROUGH SECTION FOUR

SHEET NO.  
3  
OF 17 SHEETS  
JOB NO. 21225

CONSULTING ENGINEERS - LAND SURVEYORS  
(317) 849-5835 1-800-728-6917 FAX: (317) 849-5942  
INDIANAPOLIS INDIANA

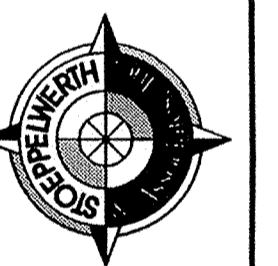

INDIANAPOLIS INDIANA



CERTIFIED: 11/11/00

*David J. Stoppelwech*

DATE

MARK

REVISIONS

BY

ADD

REV

DATE

BY

ADD

REV

DATE

BY

ADD

REV

DATE

BY

ADD

REV

DATE

BY

ADD

REV

DATE

BY

ADD

REV

DATE

BY

ADD

REV

DATE

BY

ADD

REV

DATE

BY

ADD

REV

DATE

BY

ADD

REV

DATE

BY

ADD

REV

DATE

BY

ADD

REV

DATE

BY

ADD

REV

DATE

BY

ADD

REV

DATE

BY

ADD

REV

DATE

BY

ADD

REV

DATE

BY

ADD

REV

DATE

BY

ADD

REV

DATE

BY

ADD

REV

DATE

BY

ADD

REV

DATE

BY

ADD

REV

DATE

BY

ADD

REV

DATE

BY

ADD

REV

DATE

BY

ADD

REV

DATE

BY

ADD

REV

DATE

BY

ADD

REV

DATE

BY

ADD

REV

DATE

BY

ADD

REV

DATE

BY

ADD

REV

DATE

BY

ADD

REV

DATE

BY

ADD

REV

DATE

BY

ADD

REV

DATE

BY

ADD

REV

DATE

BY

ADD

REV

DATE

BY

ADD

REV

DATE

BY

ADD

REV

DATE

BY

ADD

REV

DATE

BY

ADD

REV

DATE

BY

ADD

REV

DATE

BY

ADD

REV

DATE

BY

ADD

REV

DATE

BY

ADD

REV

DATE

BY

ADD

REV

DATE

BY

ADD

REV

DATE

BY

ADD

REV

DATE

BY

ADD

REV

DATE

BY

ADD

REV

DATE

BY

ADD

REV

DATE

BY

ADD

REV

DATE

BY

ADD

REV

DATE

BY

ADD

REV

DATE

BY

ADD

REV

DATE

BY

ADD

REV

DATE

BY

ADD

REV

S:\1225s\dwg\54-STRM.DWG\_Layout1\_09/20/2001 09:13:32 AM, mfontain, 1:1

EX. BROOKSTONE PARK

EX. SADDLE CREEK SECTION 5

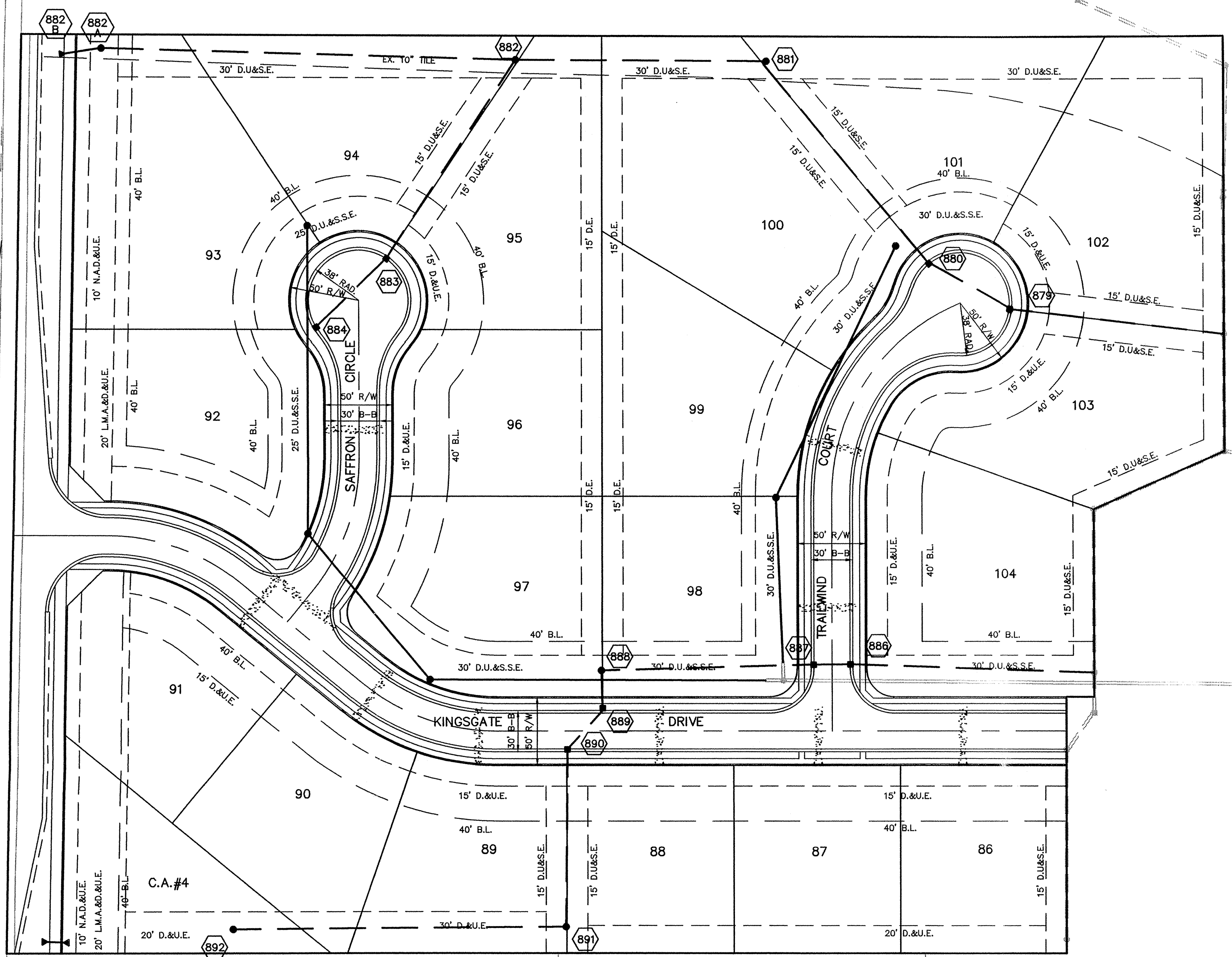

### CURB INLET TABLE

PIPE SIZE	STRUCTURES LESS THAN 48" FROM T/C TO INVERT	STRUCTURES GREATER THAN 48" FROM T/C TO INVERT	ANGLE AND QUALITY OF PIPES WILL REQUIRE SPECIAL DESIGN	STEPS REQUIRED	CURB CASTING *R-3501 N	CASTING *3501 TL & TR
12" to 18"	2'x2'		DESIGN APPROVAL	No	Yes	Yes
18" or 21"		MH/BOX	DESIGN APPROVAL	Yes	Yes	Yes
21" or 27"	2'x3'*		DESIGN APPROVAL	No	No	Yes
24" or LARGER	DESIGN APPROVAL		DESIGN APPROVAL	No	No	Yes
24" or LARGER		MH/BOX	DESIGN APPROVAL	Yes**	Yes	Yes

\* PIPES NO LARGER THAN 18" CAN BE USED IN THE 2' SIDE OF THIS BOX  
 \*\* INCOMING AND OUT GOING PIPES EFFECT STEPS IN THIS STRUCTURE

SPECIAL NOTE:  
 STRUCTURES DEEPER THAN 48" FROM T/C TO INVERT WILL BE A M.H. OR A BOX WITH STEPS UNLESS SPECIAL DESIGN IS APPROVED.

SPECIAL NOTE:  
 STRUCTURES WILL BE DESIGNED FOR MAXIMUM FLOW IN PIPES

SPECIAL NOTE:  
 COUNTY MAY REQUIRE STEPS TO BE INSTALLED AFTER STRUCTURE IS SET, TO IMPROVE ACCESS.

## RECORD DRAWING

*Jeffery W. Darling*  
 JEFFERY W. DARLING  
 Registered Land Surveyor  
 No. 900017

8/20/01  
 DATE

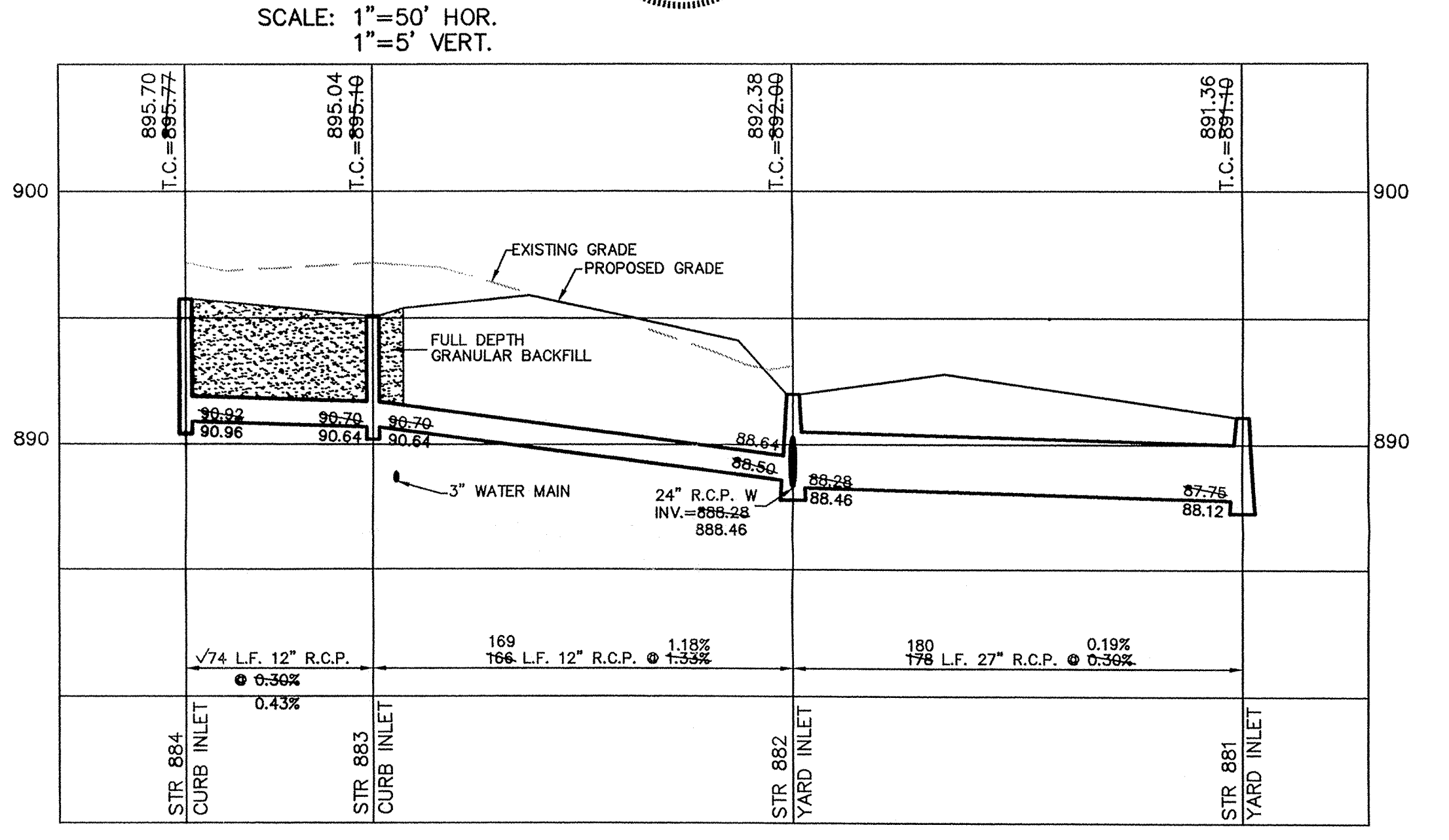

NOW OR FORMERLY  
 WATTERS  
 INST. #9961533

NOW OR FORMERLY  
 HABIG  
 INST. #88-19355

NOW OR FORMERLY  
 EADIE  
 INST. #92-35003

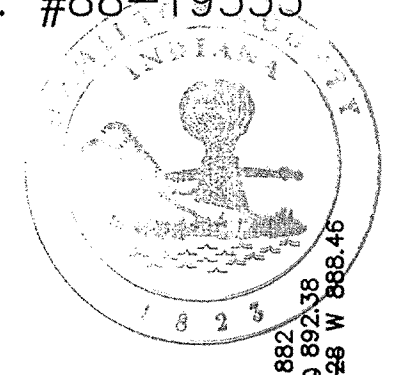
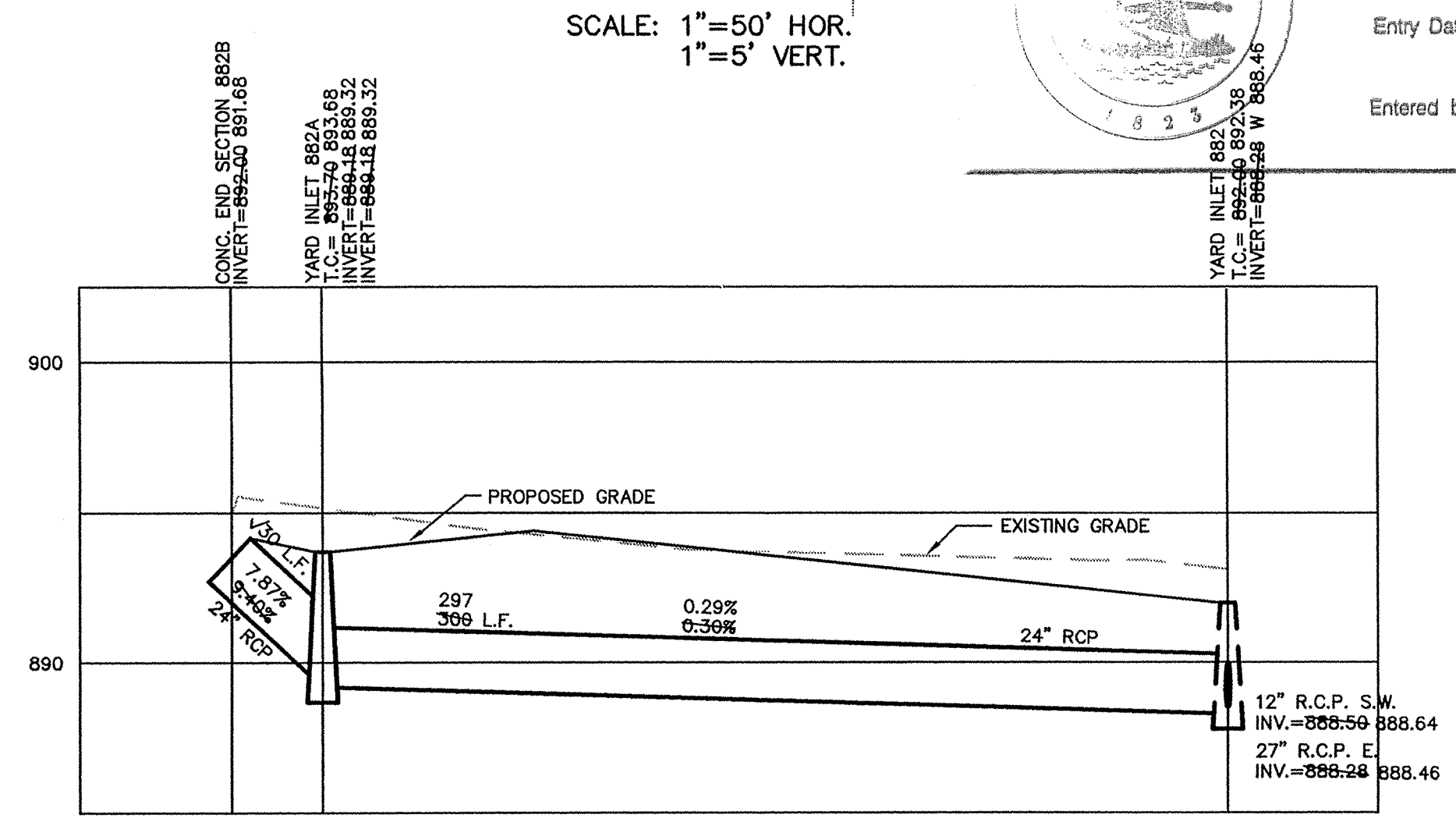

This information gathered for input into a Geographic Information System (GIS) document is considered a record of the GIS.  
 Entry Date: 2-14-02  
 Entered by: SWA JDH

SCALE: 1" = 50'

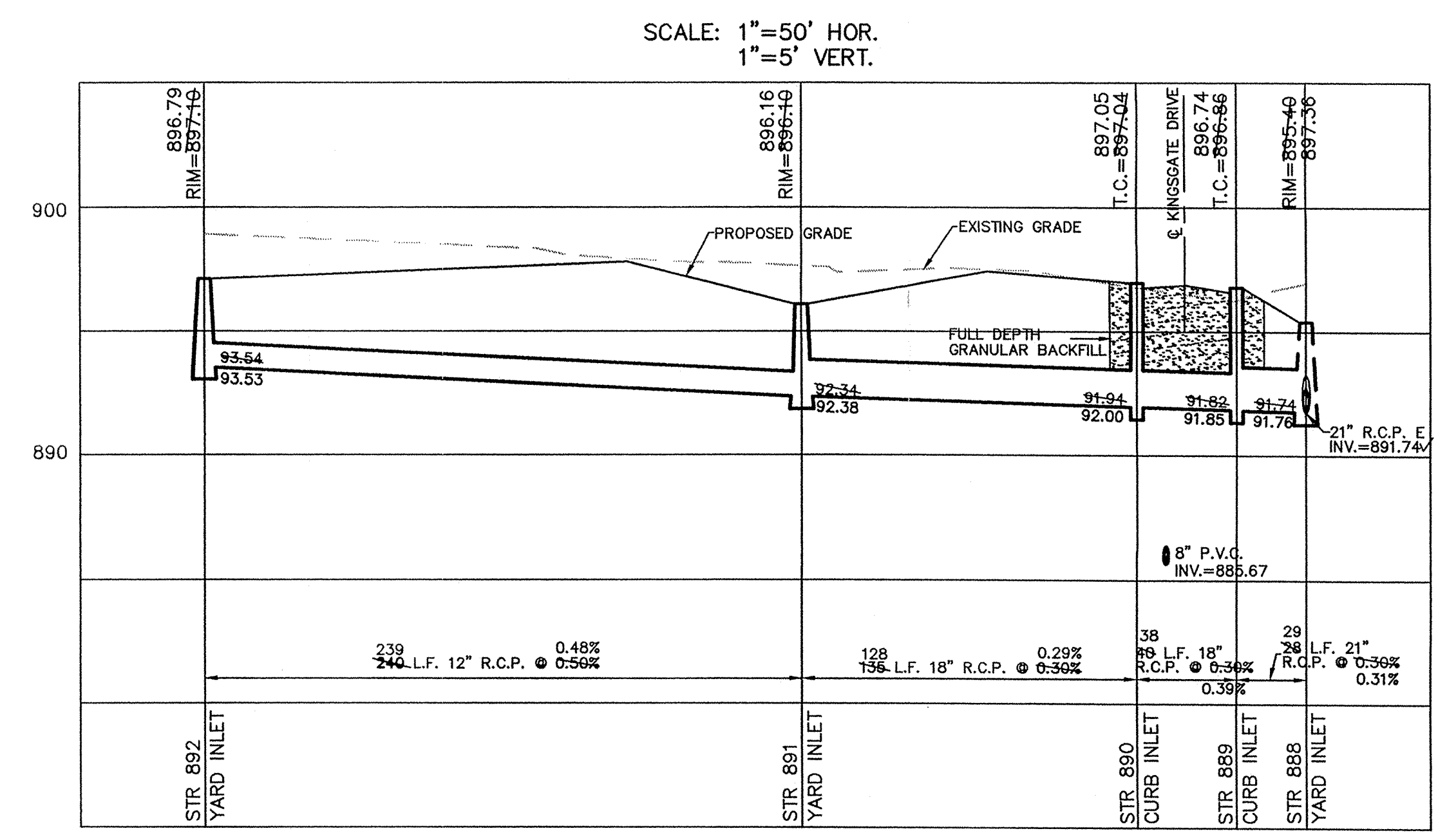

**FILED**  
 SEP 06 2001  
 OFFICE OF HAMILTON COUNTY SURVEYOR

STORM SEWER PLAN & PROFILE  
 KINGSBOROUGH SECTION FOUR

CONSULTING ENGINEERS - LAND SURVEYORS  
 (317) 849-5935 1-800-728-6917 FAX: (317) 849-5942  
 INDIANAPOLIS INDIANA

SHEET NO. 11  
 OF 17 SHEETS  
 JOB NO. 21225

CERTIFIED: 11/11/00  
 DATE

BY: *David J. Stoppelwech*

# RECORD DRAWING

*Jeffery W. Darling*  
 JEFFERY W. DARLING  
 Registered Land Surveyor  
 No. 900017  
 DATE 8/20/01

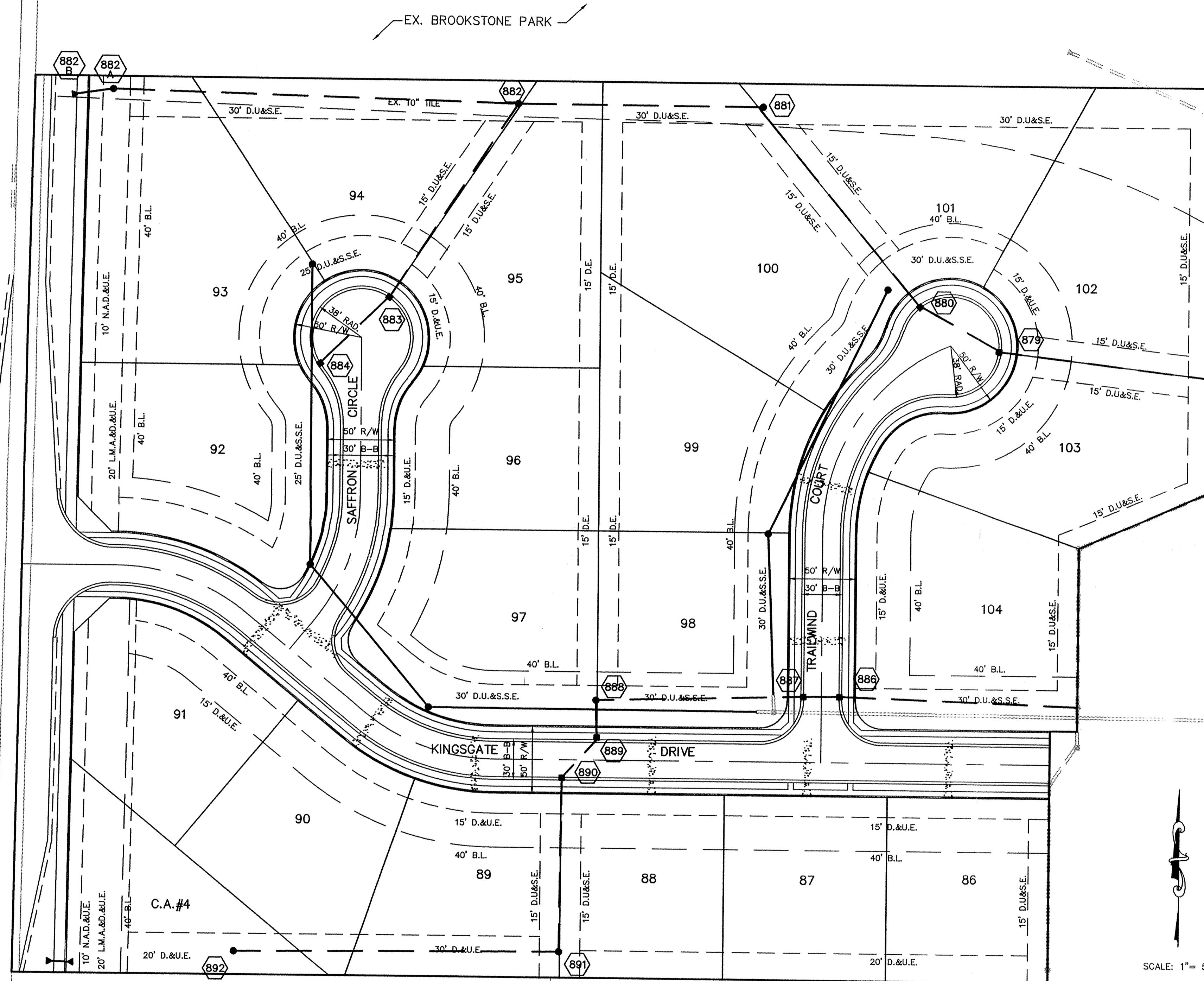

NOW OR FORMERLY  
 WATTERS  
 INST. #9961533

NOW OR FORMERLY  
 HABIG  
 INST. #88-19355

NOW OR FORMERLY  
 EADIE  
 INST. #92-35003



This information was gathered for input into the Hamilton County Geographical Information System. This document is considered an official record of the GIS.

Entry Date: 2-14-02  
 Entered by: SLM/10/19/04

### CURB INLET TABLE

PIPE SIZE	STRUCTURES LESS THAN 48" FROM T/C TO INVERT	STRUCTURES GREATER THAN 48" FROM T/C TO INVERT	ANGLE AND QUALITY OF PIPES WILL REQUIRE SPECIAL DESIGN	STEPS REQUIRED	CURB CASTING *R-3501 N	CASTING *3501 TL & TR
12" to 18"	2'x2'		DESIGN APPROVAL	No	Yes	Yes
18" or 21"		MH/BOX	DESIGN APPROVAL	Yes	Yes	Yes
21" or 27"	2'x3'*		DESIGN APPROVAL	No	No	Yes
24" or LARGER	DESIGN APPROVAL		DESIGN APPROVAL	No	No	Yes
24" or LARGER		MH/BOX	DESIGN APPROVAL	Yes**	Yes	Yes

\* PIPES NO LARGER THAN 18" CAN BE USED IN THE 2' SIDE OF THIS BOX  
 \*\* INCOMING AND OUT GOING PIPES EFFECT STEPS IN THIS STRUCTURE

SPECIAL NOTE:  
 STRUCTURES DEEPER THAN 48" FROM T/C TO INVERT WILL BE A M.H. OR A BOX WITH STEPS UNLESS SPECIAL DESIGN IS APPROVED.  
 SPECIAL NOTE:  
 STRUCTURES WILL BE DESIGNED FOR MAXIMUM FLOW IN PIPES  
 SPECIAL NOTE:  
 COUNTY MAY REQUIRE STEPS TO BE INSTALLED AFTER STRUCTURE IS SET, TO IMPROVE ACCESS.

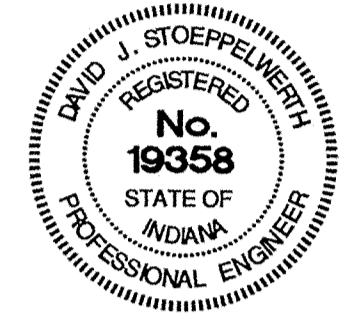

SCALE: 1" = 50' HOR.  
 1" = 5' VERT.

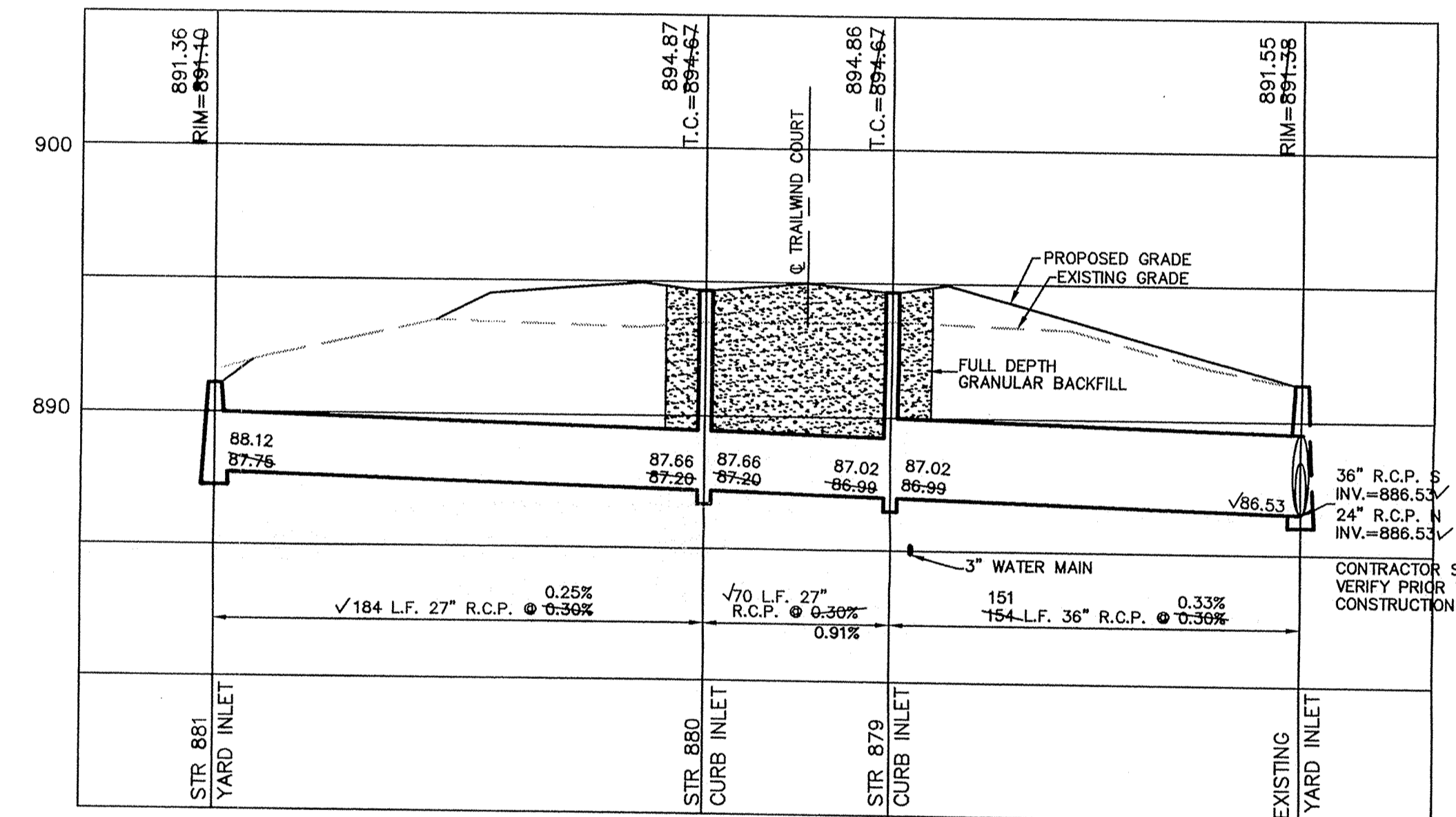

SCALE: 1" = 50' HOR.  
 1" = 5' VERT.

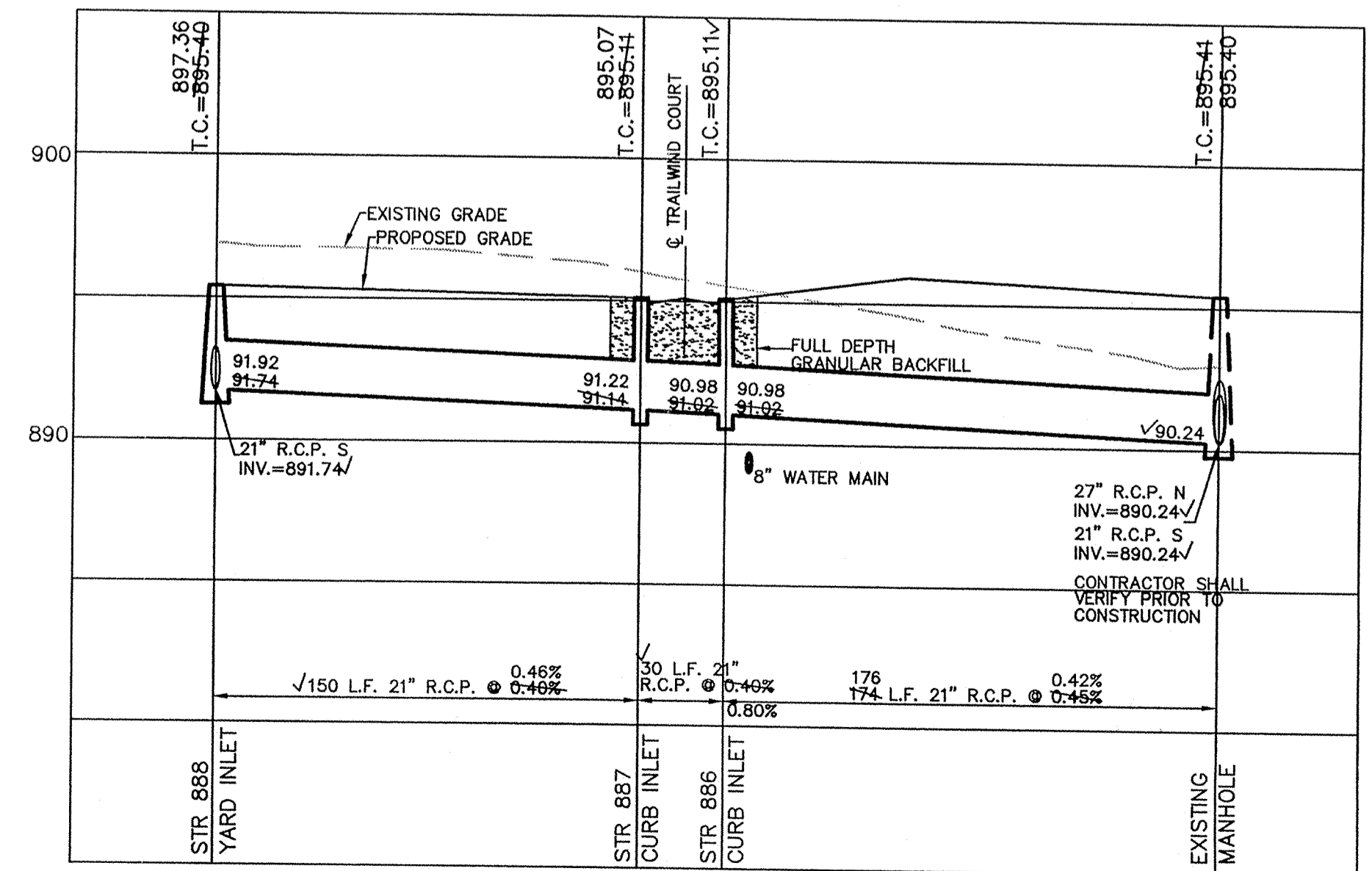

CERTIFIED: 11/11/00  
 CONSULTING ENGINEERS - LAND SURVEYORS  
 (317) 849-5935 1-800-728-6917 FAX: (317) 849-5942  
 INDIANAPOLIS INDIANA  
 STORM SEWER PLAN & PROFILE  
 KINGSBOROUGH SECTION FOUR  
 CARMEL INDIANA  
 SHEET NO. 12  
 SEP 06 2001  
 OFFICE OF HAMILTON COUNTY SURVEYORS  
 JOB NO. 21225

S:\21225\dwg\SA-STRM1.DWG, Layout1, 08/20/2001 09:21:28 AM, mfontain, 1:1